



# International School Rheintal

➤ Buchs, Switzerland

➤ Jahr / 2023

**Kategorie** / Culture

**Autor** / Kämpfen Zinke + Partner

**Fotos** / Linus Lintner

With its open, transparent and sustainable design, the building forms a modern learning landscape for the **International School Rheintal** and is a model for a sustainable future.

**Sustainability** is consistently implemented in the pure timber construction made of regional spruce wood, from the photovoltaic system to the energy-efficient lighting and the intensive green roof.



Alphabet of Light - Bjarke Ingels Group





Alphabet of Light Circular - Bjarke Ingels Group

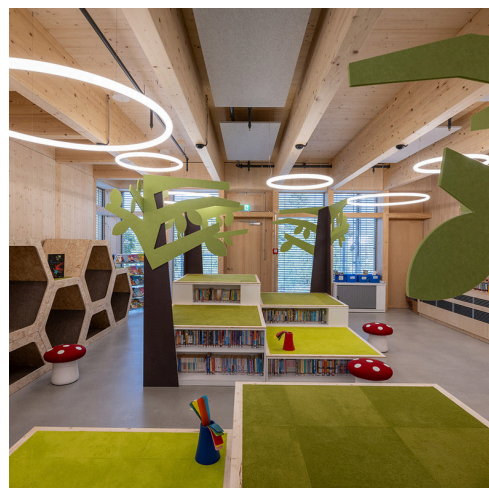

Alphabet of Light Circular - Bjarke Ingels Group

**Alphabet of Light**, both system and stand alone, perfectly integrate within these very simple and minimal environments, perfectly fulfilling the task of illuminating with a light that is not only functional but also aesthetically pleasing. The Artemide lighting solution seamlessly becomes part of the architectural narrative, enhancing the overall atmosphere within the school. The choice of Alphabet of Light aligns seamlessly with the **sustainability ethics** embraced by the International School Rheintal. Artemide's commitment to sustainable solutions is reflected in the product's energy efficiency and use of recyclable materials.



Alphabet of Light System - Bjarke Ingels Group

**Alphabet of Light** by Artemide not only illuminates the spaces within the International School Rheintal but also sheds light on the school's dedication to a greener and more sustainable future.



Alphabet of Light System - Bjarke Ingels Group



Alphabet of Light System - Bjarke Ingels Group