



# Timber Pioneer

Frankfurt, Germany

Año / 2025

Categoría / Office

Autor / W+P Workspace Consulting

Artemide illuminates **Timber Pioneer**, the first office project in Frankfurt built with a hybrid timber structure. With over 14,000 square metres of contemporary and sustainable workspaces, the building stands as a **flagship project in the field of green building** and interprets a new idea of the professional environment: efficient, flexible and focused on people's well-being.

In dialogue with the architecture and the strong material identity of the project, Artemide creates an **articulated lighting scenario**, designed to accompany the different functions of the spaces and enhance their perceptual quality.





A.24 System - Carlotta de Bevilacqua

The numerous Artemide solutions create different layers of light: from the functional illumination of **A.24** for the operational areas to the scenic accents of **Alphabet of Light** and **Gople System** for shared spaces. The result is a coherent and flexible intervention, designed to meet the **needs of contemporary work**, support visual comfort throughout the day and make visible **a new balance between technology, nature and well-being**.



Alphabet of Light Circular - BIG Bjarke Ingels Group

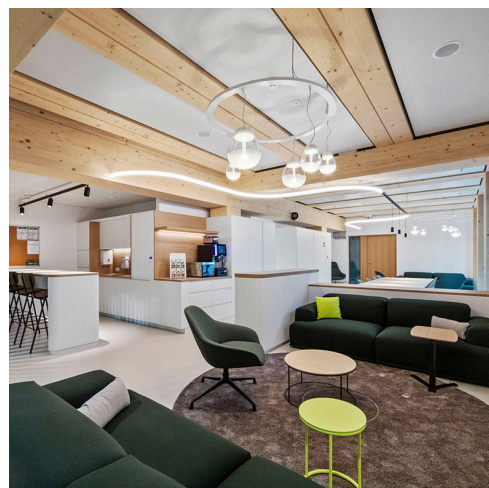

Empatia Custom Cluster - Carlotta de Bevilacqua |



A.24 System - Carlotta de Bevilacqua